



## Quick Guide LILIAN Manager Software

# Overview

# Offline

Data only  
backed up  
on smartphone

=

UNSAFE



LILIAN App

# Online

Data stored in  
online database

=

SAFE

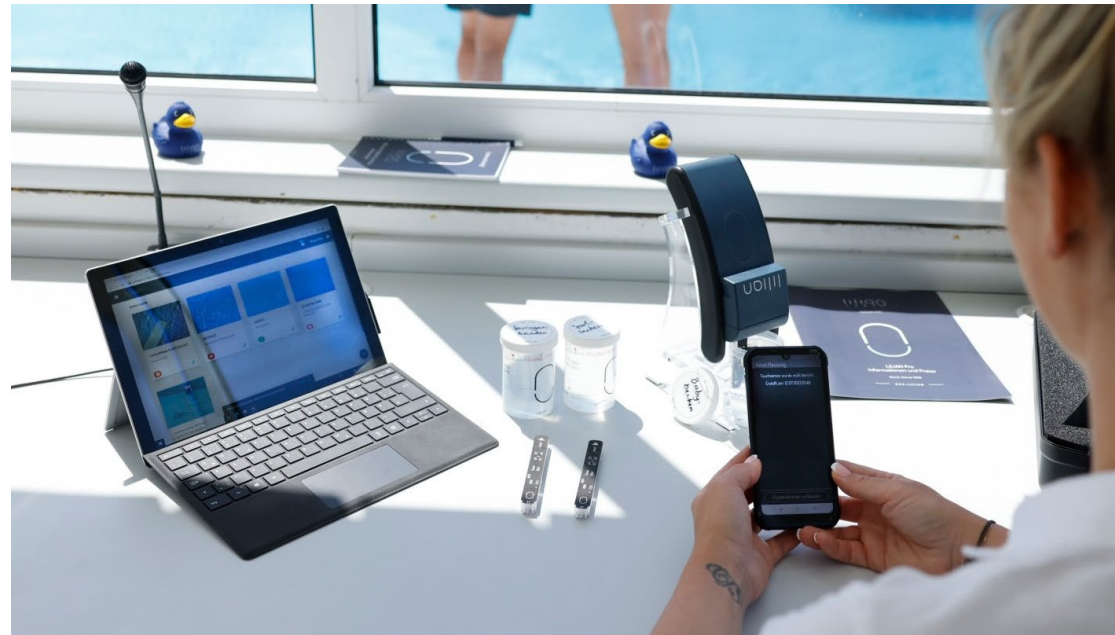

LILIAN Manager

- App
- Dashboard
- Interface

# LILIAN Manager functions overview

	LILIAN App	LILIAN Manager	Free version includes
Operation of the LILIAN	✓	✓	✓
Saving the measured values	✓	✓	✓
Offline Functionality	✓	✓	✓
Diagnosis of the LILIAN	✓	✗	✓
Assignment of data to locations, vessels and persons	✗	✓	✓
Export function	✗	✓	✓
Graphical display of measured values and daily report	✗	✓	✓
Automatic correction of measured values (Offsets)	✗	✓	✓
Manual parameters for digital operating manual	✗	✓	✓
Interface to existing software solution	✗	✓	\$
Alarm management when limit values are exceeded	✗	✓	\$

The background image shows a person's hand typing on a laptop keyboard. The laptop screen displays the LILIAN software interface, which features a table of data. The table has columns for dates, names, and numerical values. Some rows are highlighted in yellow. In the foreground, a tablet displays a line graph representing the data from the table. The graph shows a fluctuating blue line over time. A blue pen lies on the desk next to the tablet.

## Where can I find documentation?

The LILIAN app and the LILIAN Manager app are available in the Google Store. There is an initial version in the iOS Store that enables the monitoring of measured values without a measurement function.

The manual for the software is available at  
<https://lilianlabs.com/downloads>.

The documentation for the LILIAN Manager API can be found at:  
<https://lilianconnect.docs.apiary.io/#>.

The LILIAN app and the LILIAN Manager app are available in the Google Store. There is an initial version in the iOS Store that enables the monitoring of measured values without a measurement function.

The manual for the software is available at <https://lilianlabs.com/downloads>.

The documentation for the LILIAN Manager API can be found at:  
**<https://lilianconnect.docs.apiary.io/#>**.

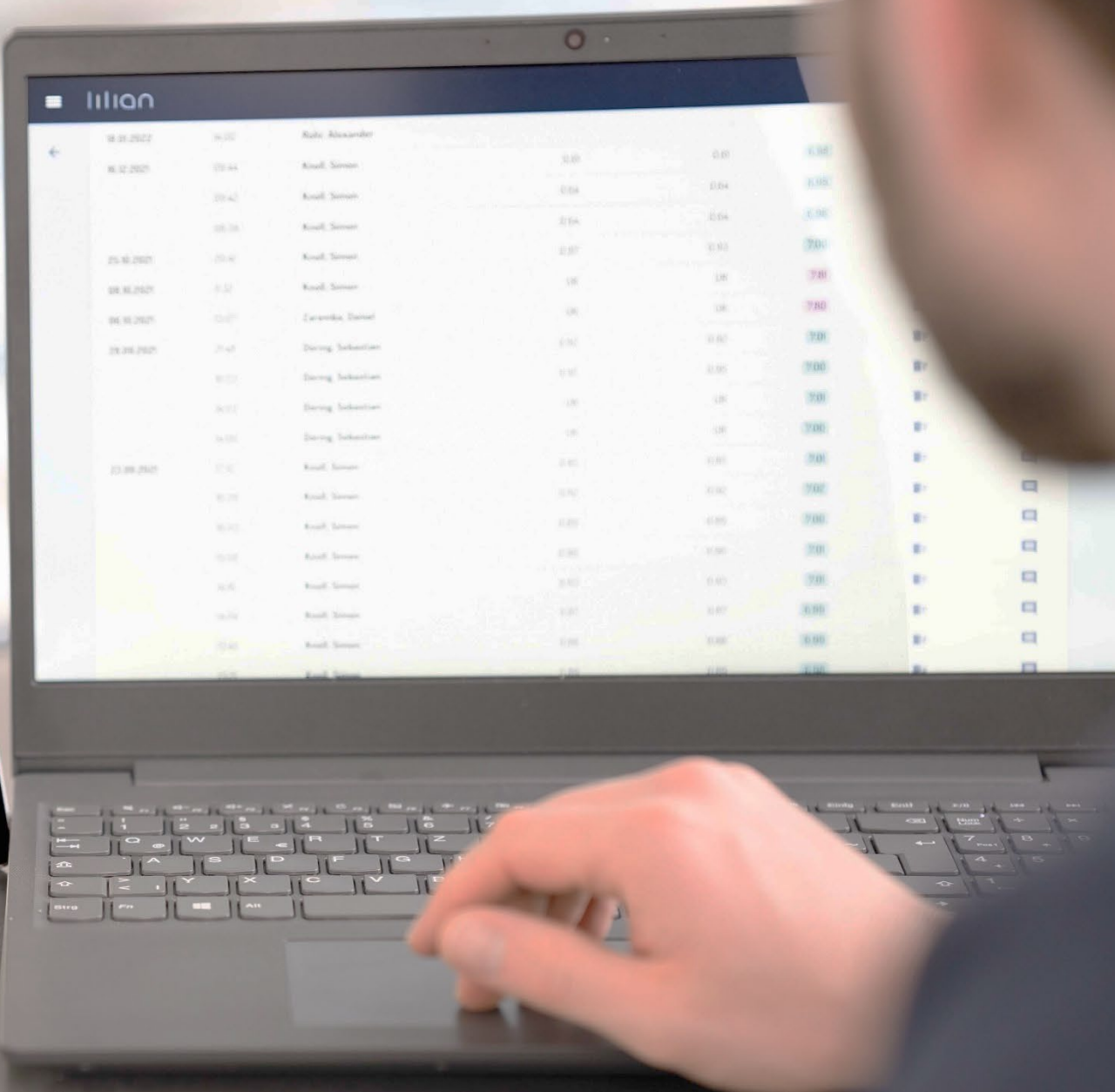

Step by step setup guide

Internet address Lilian Manager

Log in with your user account!



Lilian Manager

Log in with your email and password.

EMAIL

PASSWORD

RESET PASSWORD

LOG IN

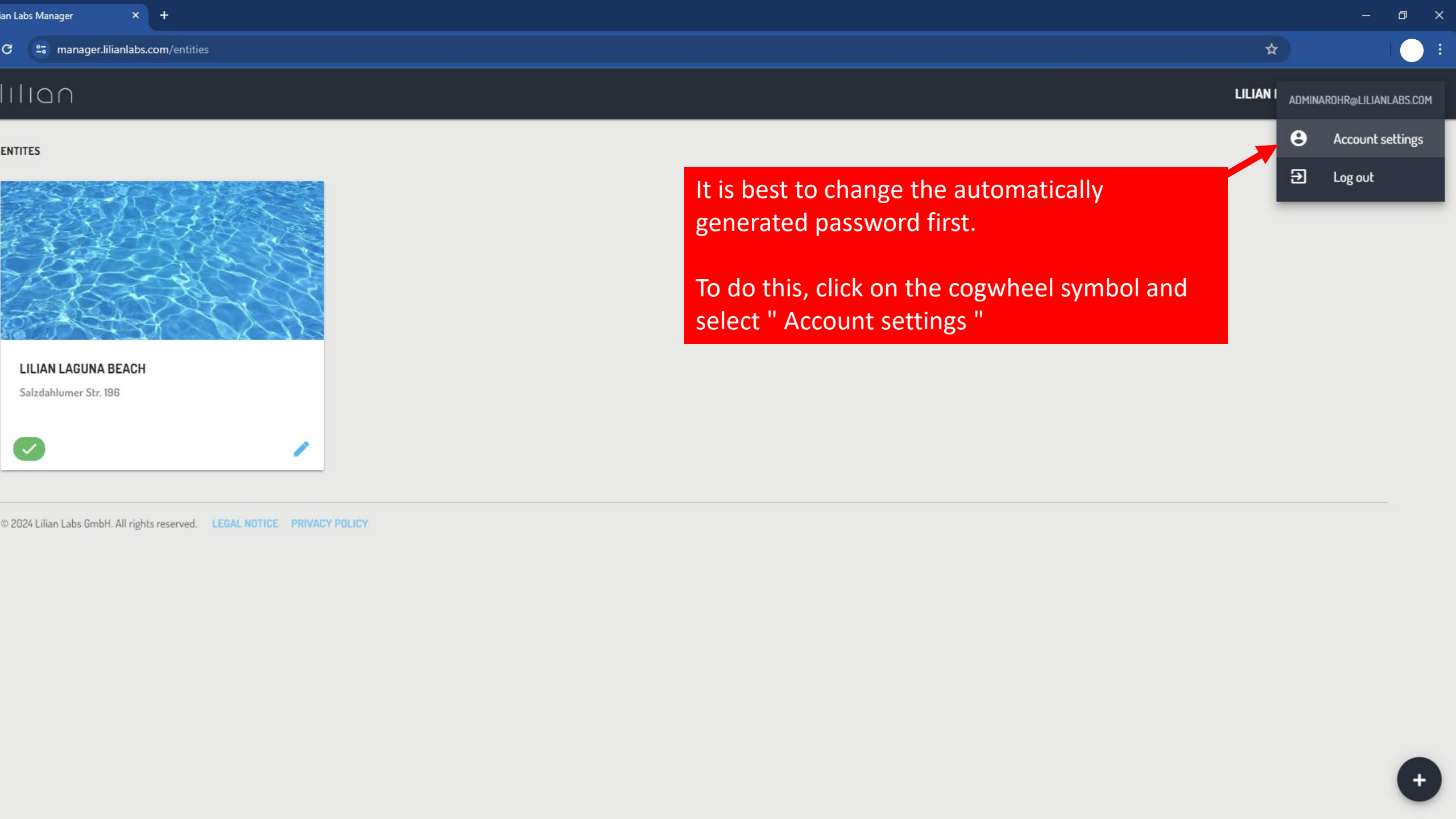

## ENTITIES



## LILIAN LAGUNA BEACH

Salzdahlumer Str. 196



It is best to change the automatically generated password first.

To do this, click on the cogwheel symbol and select " Account settings "

 Account settings Log out

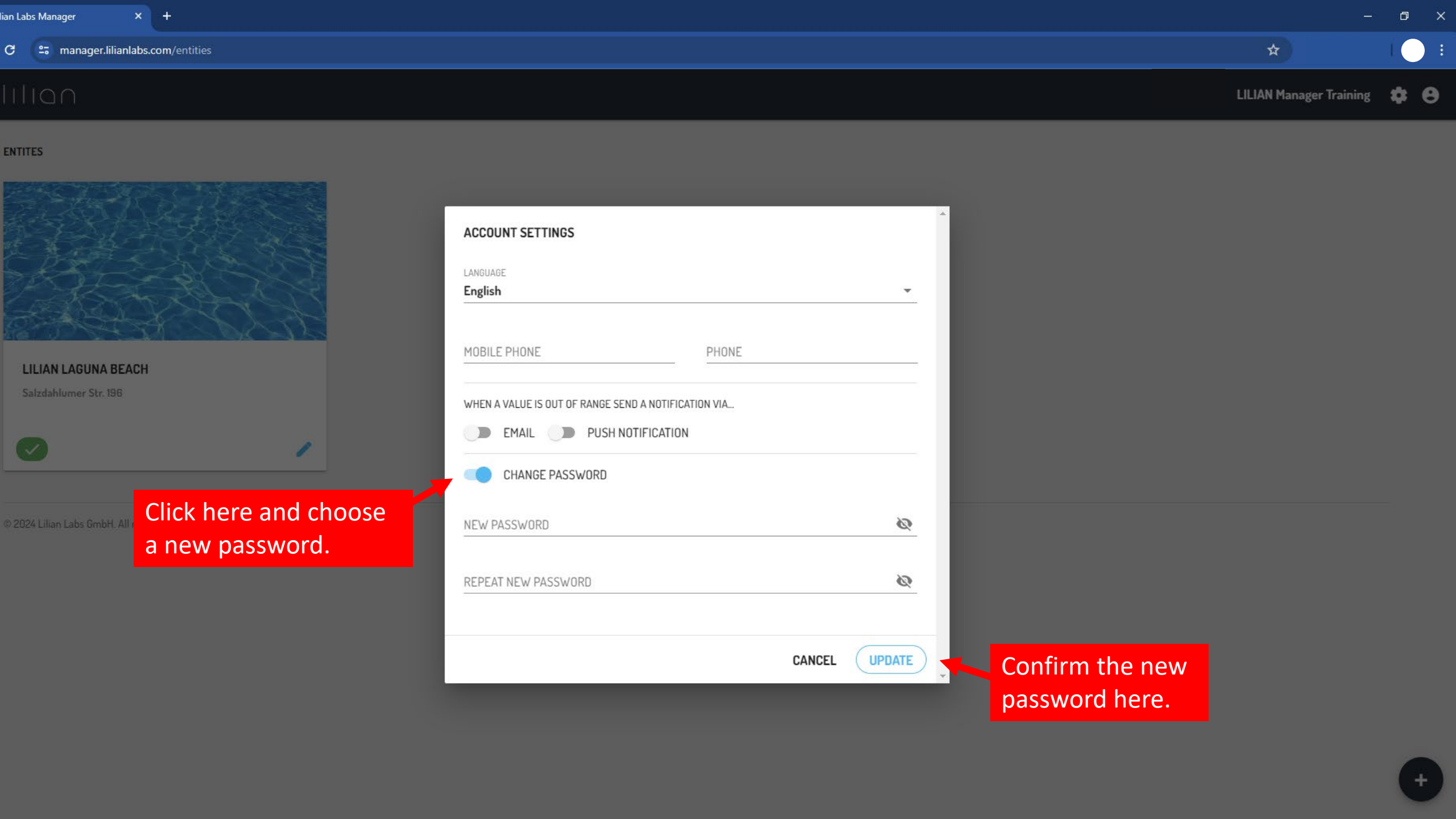

ACCOUNT SETTINGS

LANGUAGE

English

MOBILE PHONE

PHONE

WHEN A VALUE IS OUT OF RANGE SEND A NOTIFICATION VIA...



EMAIL



PUSH NOTIFICATION



CHANGE PASSWORD

NEW PASSWORD



REPEAT NEW PASSWORD



CANCEL

UPDATE

Click here and choose  
a new password.

Confirm the new  
password here.

ENTITIES

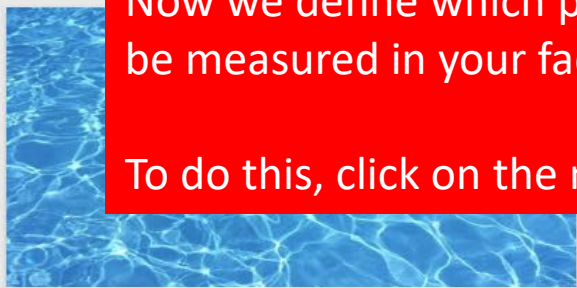

**LILIAN LAGUNA BEACH**  
Salzdahlumer Str. 196

✓



Now we define which parameters are to be measured in your facility in general.

To do this, click on the main menu.

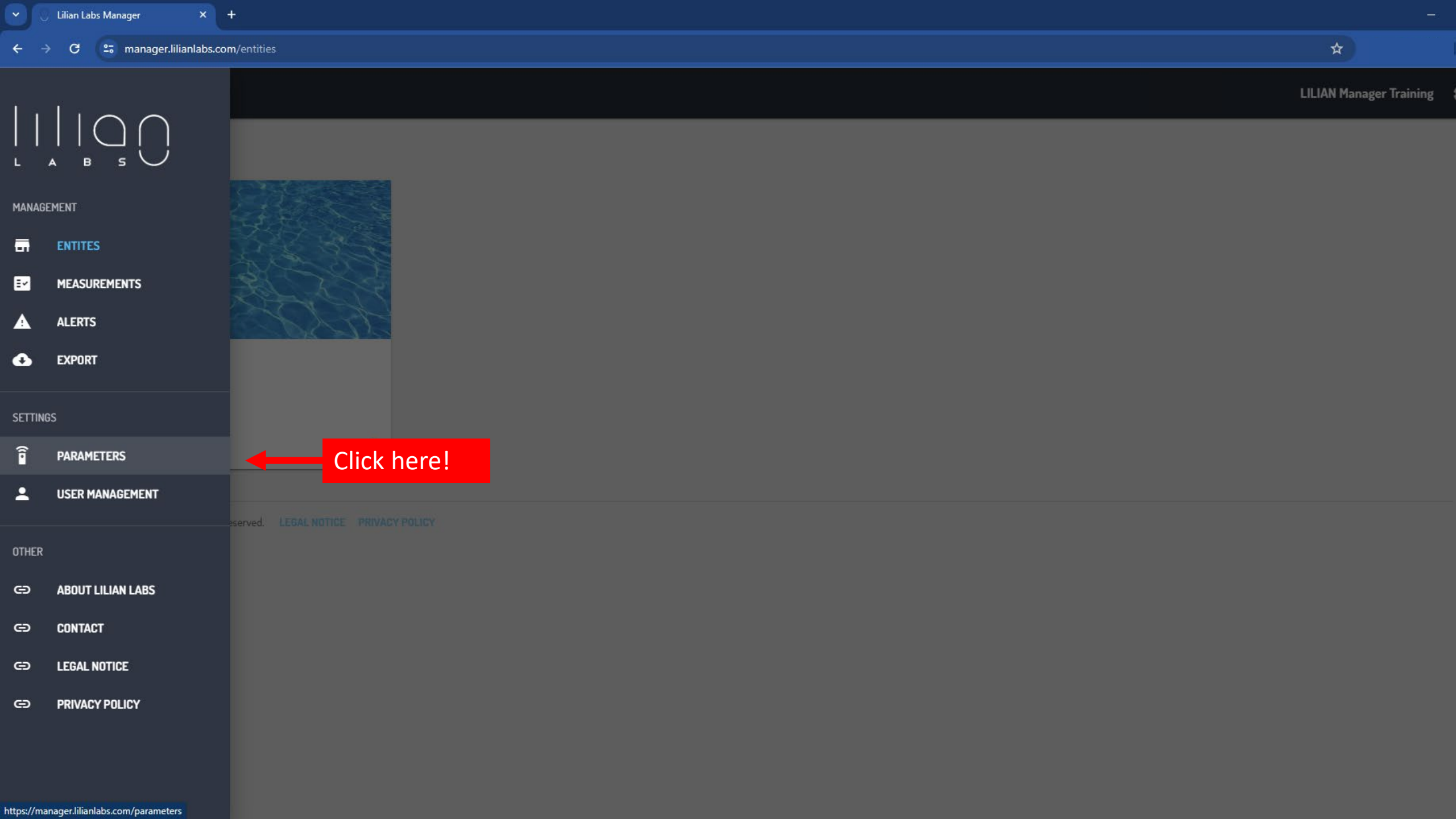

Click here!

PARAMETERS

Choose your parameters and change their order.



No results found

Create parameters!



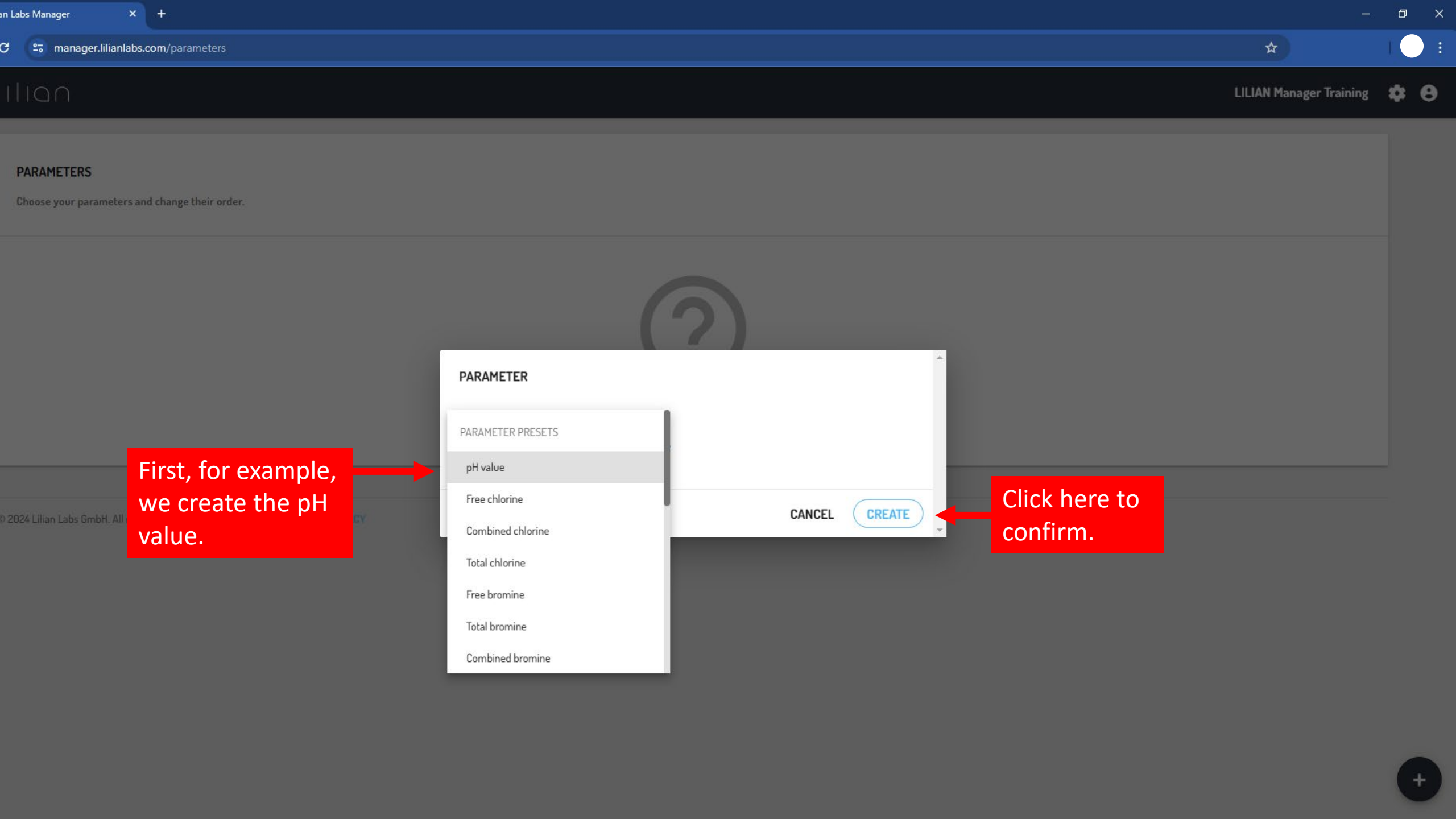

PARAMETERS

Choose your parameters and change their order.

PARAMETER

PARAMETER PRESETS

- pH value
- Free chlorine
- Combined chlorine
- Total chlorine
- Free bromine
- Total bromine
- Combined bromine

CANCEL

CREATE

First, for example, we create the pH value.

Click here to confirm.

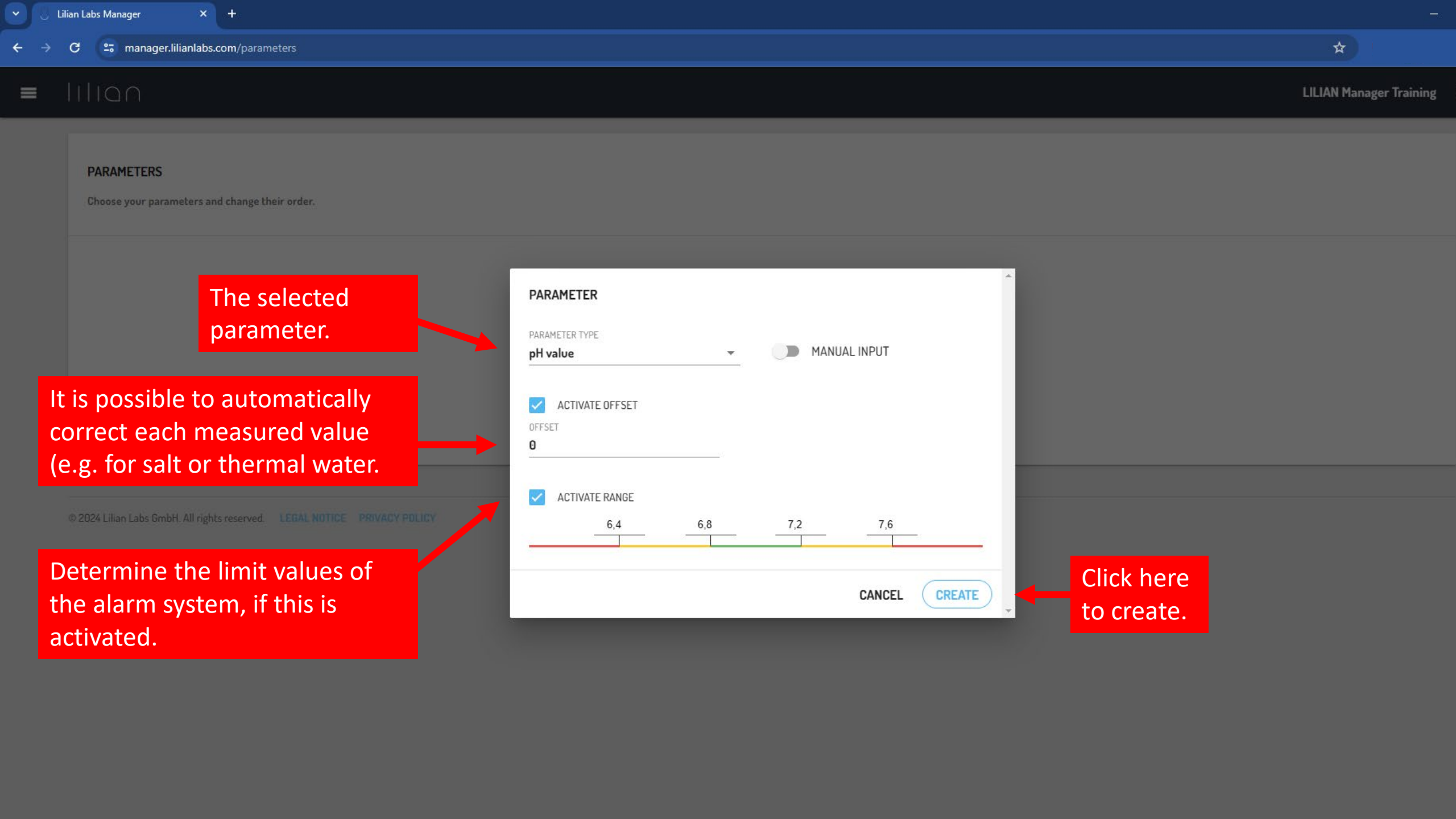

The selected parameter.

It is possible to automatically correct each measured value (e.g. for salt or thermal water.)

Determine the limit values of the alarm system, if this is activated.

Click here to create.

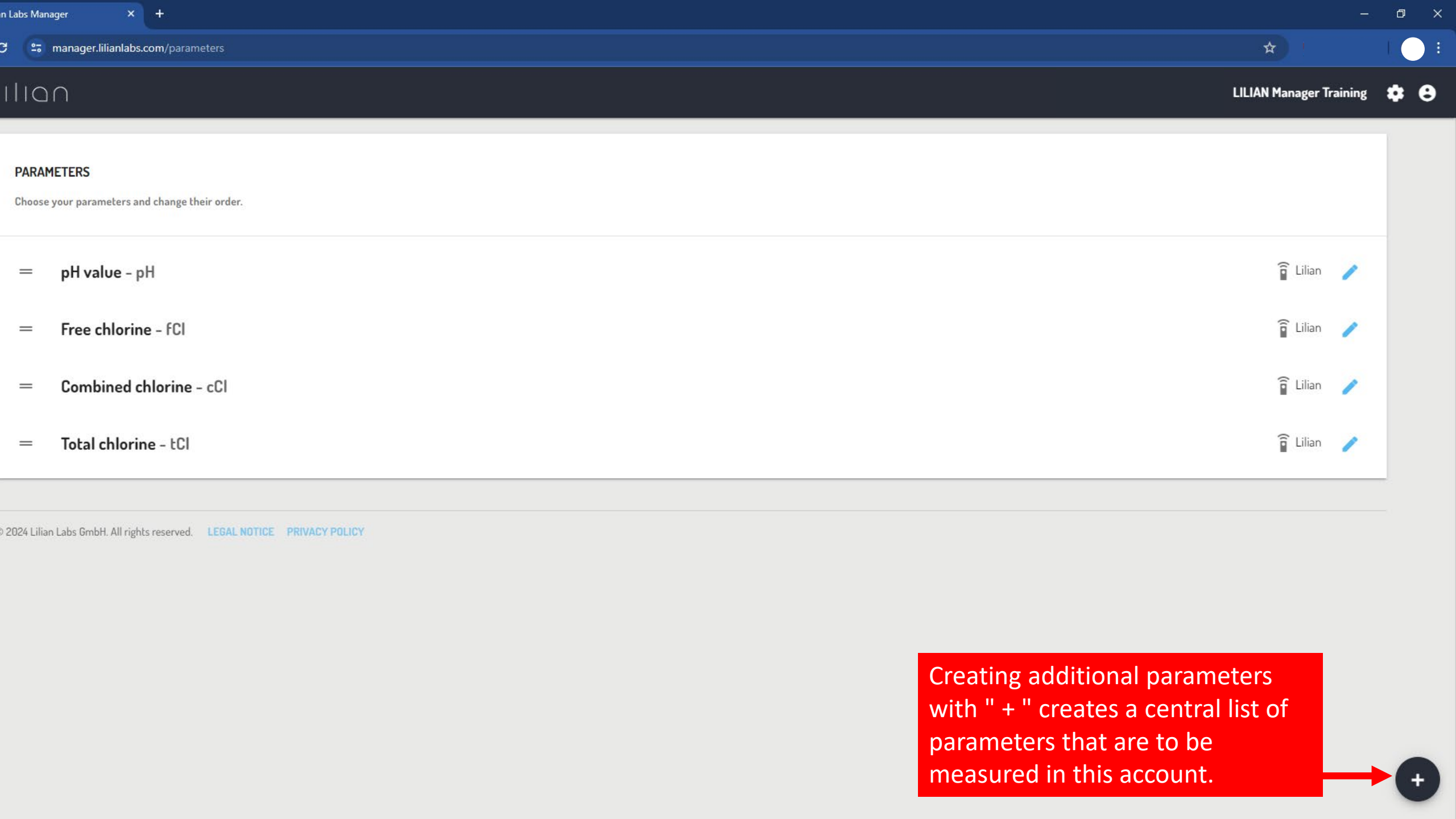

## PARAMETERS

Choose your parameters and change their order.

= pH value - pH

📱 Lilian ✎️

= Free chlorine - fCl

📱 Lilian ✎️

= Combined chlorine - cCl

📱 Lilian ✎️

= Total chlorine - tCl

📱 Lilian ✎️

Creating additional parameters with " + " creates a central list of parameters that are to be measured in this account.



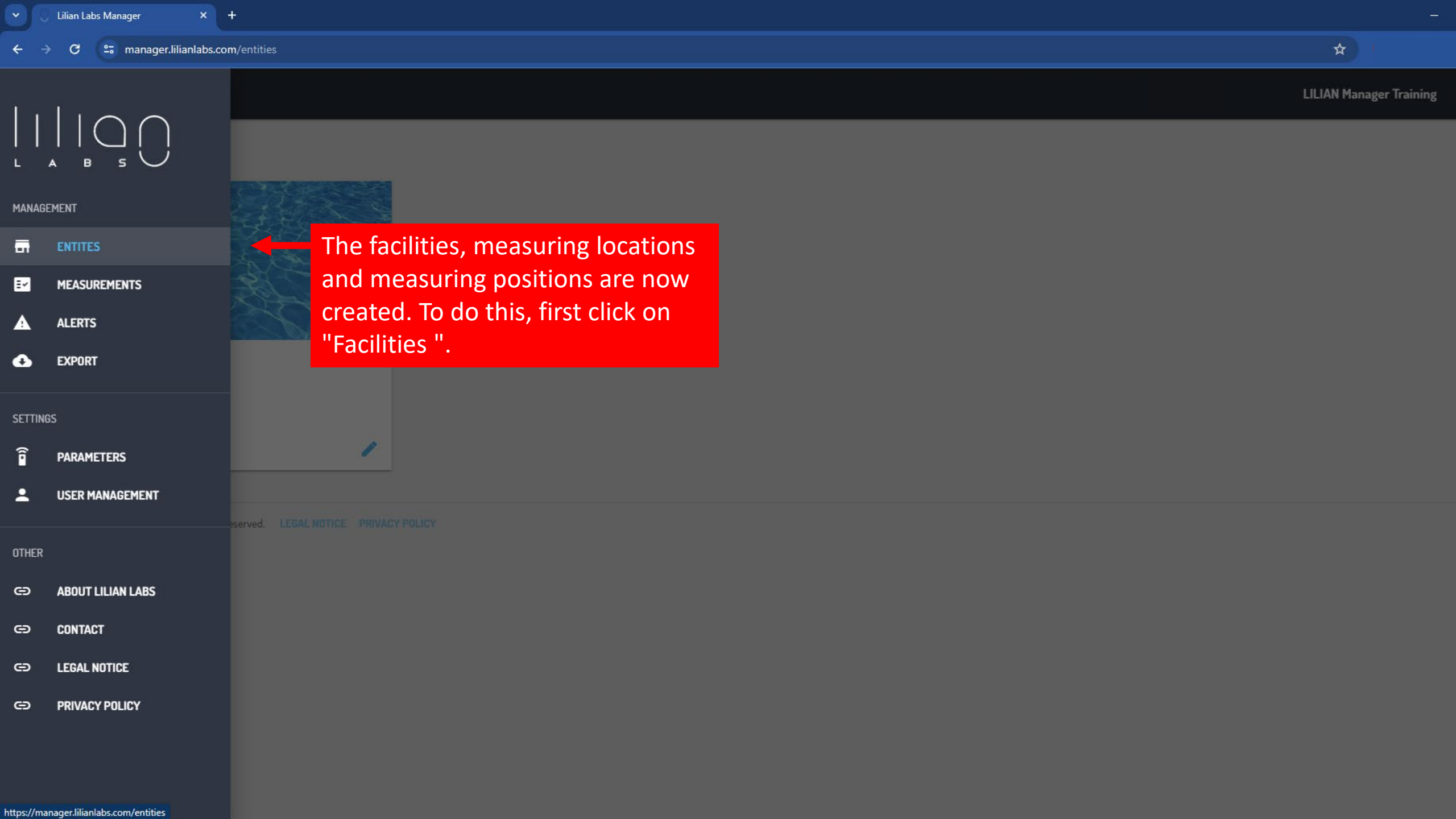

MANAGEMENT

 ENTITIES

 MEASUREMENTS

 ALERTS

 EXPORT

SETTINGS

 PARAMETERS

 USER MANAGEMENT

OTHER

 ABOUT LILIAN LABS

 CONTACT

 LEGAL NOTICE

 PRIVACY POLICY

The facilities, measuring locations and measuring positions are now created. To do this, first click on "Facilities ".

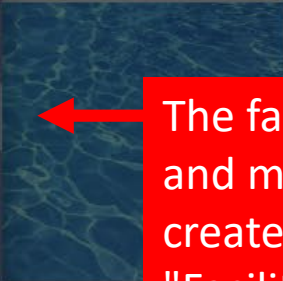



ENTITIES



LILIAN LAGUNA BEACH

Salzdahlumer Str. 196



Click here to create  
a new facility.



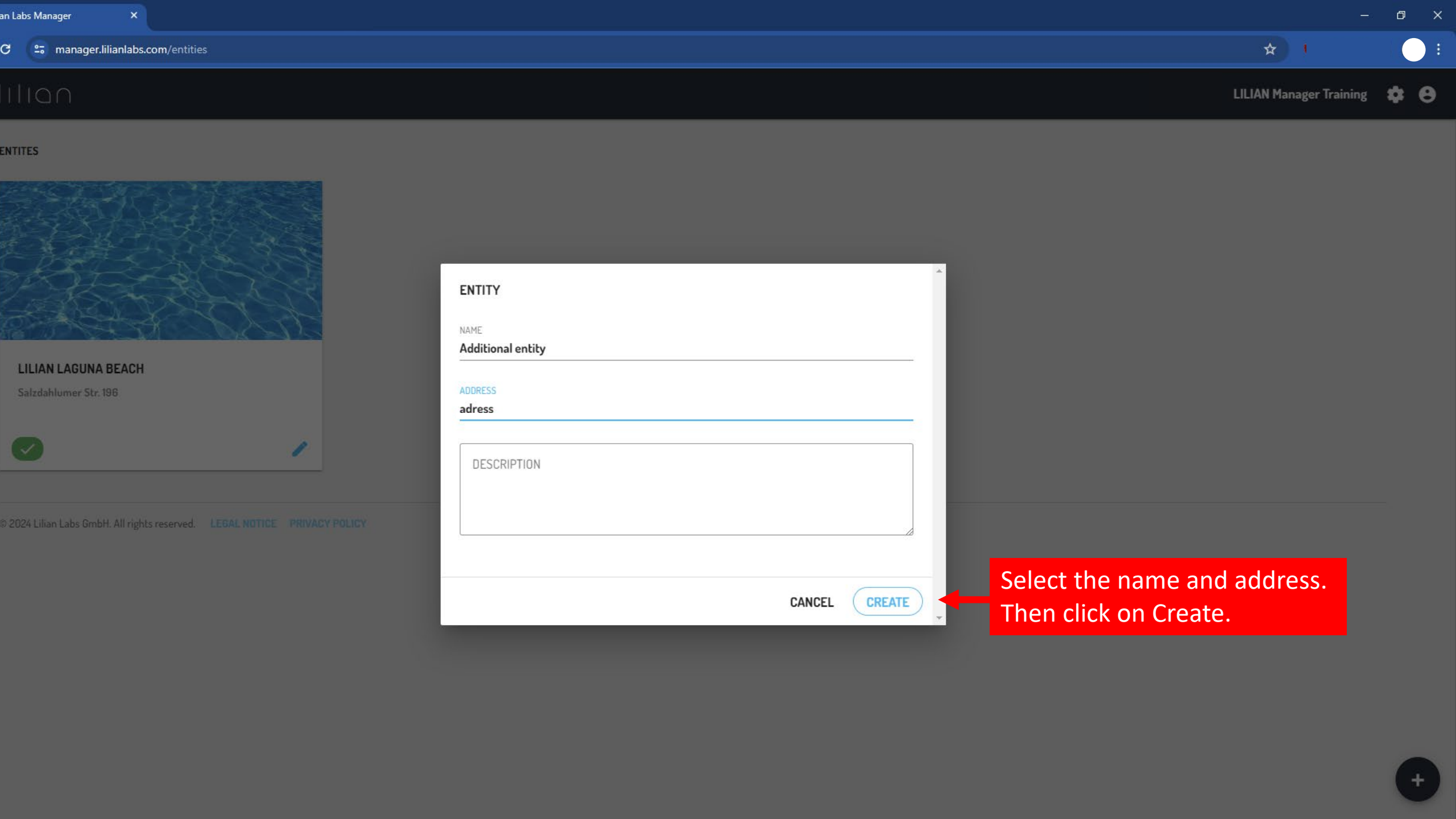

h Labs Manager

manager.lilianlabs.com/entities

LILIAN Manager Training

NTITES



LILIAN LAGUNA BEACH

Salzdahlumer Str. 196

✓



ADDITIONAL ENTITY

adress

✓

2024 Lilian Labs GmbH. All rights reserved. [LEGAL NOTICE](#) [PRIVACY POLICY](#)

The new public swimming pool appears in the list. Click here!

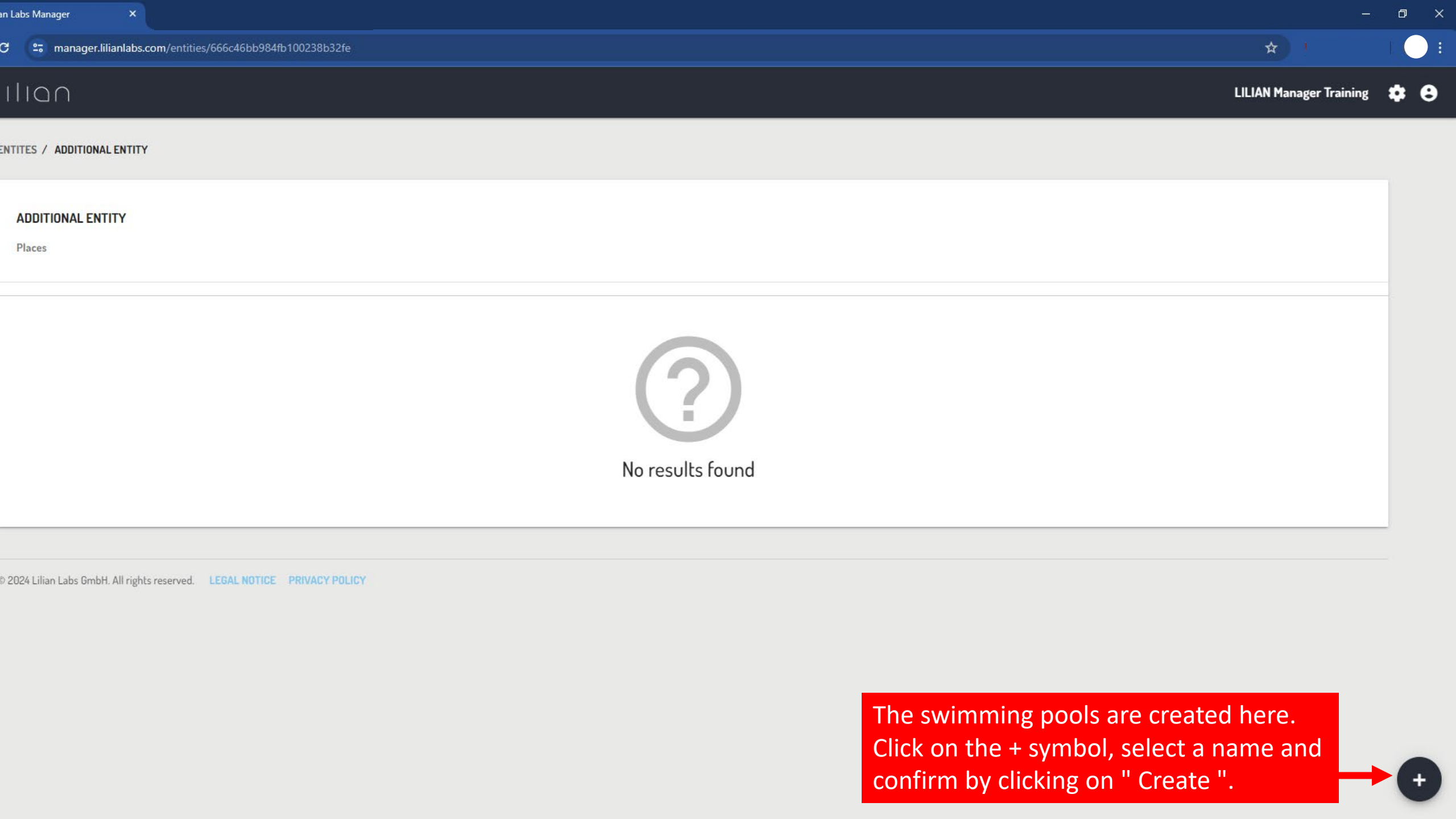

ADDITIONAL ENTITY

Places



No results found

The swimming pools are created here.  
Click on the + symbol, select a name and  
confirm by clicking on " Create " .



in Labs Manager

manager.lilianlabs.com/entities/666c46bb984fb100238b32fe

LILIAN Manager Training

NTITIES / ADDITIONAL ENTITY

GO TO...

ADDITIONAL ENTITY

Places

STATUS	NAME	DESCRIPTION
✓	children pool	

The basin appears in the list. Click on it!

© 2024 Lilian Labs GmbH. All rights reserved.

[LEGAL NOTICE](#)

[PRIVACY POLICY](#)

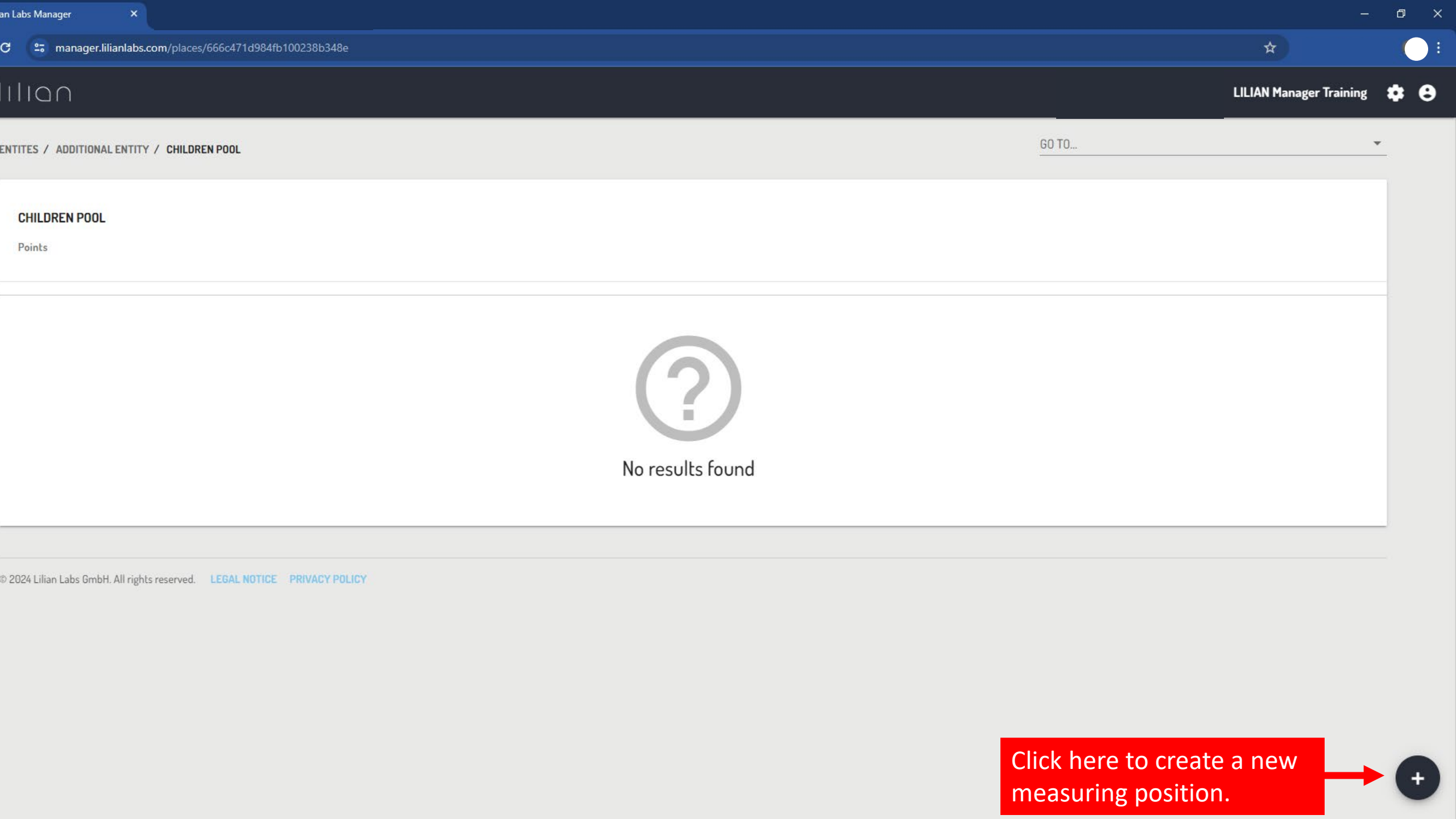

CHILDREN POOL

Points



No results found

Click here to create a new measuring position.



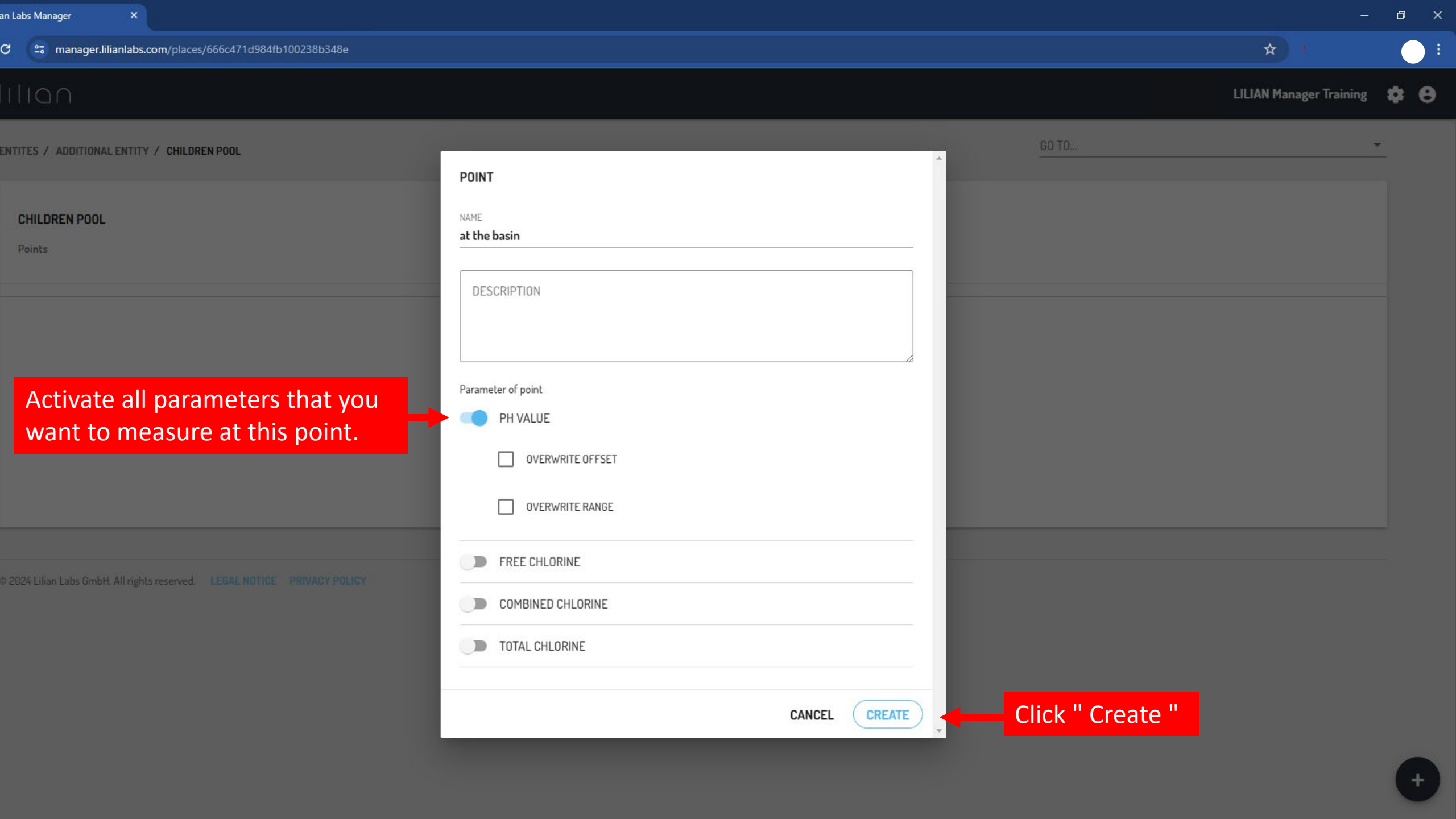

ENTITIES / ADDITIONAL ENTITY / CHILDREN POOL

CHILDREN POOL

Points

GO TO...

## POINT

NAME

at the basin

DESCRIPTION

Parameter of point



PH VALUE



OVERWRITE OFFSET



OVERWRITE RANGE



FREE CHLORINE



COMBINED CHLORINE



TOTAL CHLORINE

CANCEL

CREATE

Click " Create "

an Labs Manager

manager.lilianlabs.com/places/666c471d984fb100238b348e

LILIAN Manager Training

ENTITIES / ADDITIONAL ENTITY / CHILDREN POOL

GO TO...

CHILDREN POOL

Points

STATUS	NAME	DESCRIPTION
✓	at the basin	

The measuring point appears in the list. Click here.

© 2024 Lilian Labs GmbH. All rights reserved. [LEGAL NOTICE](#) [PRIVACY POLICY](#)

+

Everything is now ready for the user to generate new measurements in the application.



lilianlabsgmbh@gmail.com

.....

LOG IN

By logging in you accept our terms and privacy policy:

PRIVACY POLICY

GENERAL TERMS AND CONDITIONS

FORGOT PASSWORD?

v0.5.151 production

SETTINGS

CLIENT

LILIAN Manager Schulung

ENTITY

Please select... ▼

Lilian Laguna Beach

Example Pool

CHANGE PASSWORD

LOG OUT

OTHER

ABOUT LILIAN LABS

LEGAL NOTICE

PRIVACY POLICY

GENERAL TERMS AND CONDITIONS



MEASURE

ENTITY

Example Pool

PLACE

Baby Pool ▼

POINT

Poolside ▼

LAST MEASUREMENT

📅 ⌚ pH fCl cCl

Keine Messwerte vorhanden

NEW MEASUREMENT

MEASURE

an Labs Manager

manager.lilianlabs.com/points/63eb9e387c7eac001ed743bb

LILIAN Manager Training

ENTITIES / LILIAN LAGUNA BEACH / SPORTBECKEN / AM BECKENRAND

SPORTBECKEN

Am Beckenrand

LAYOUT

List

RANGE

Last 100 measurements

GO TO...

GO TO POINT...

EXPORT AS .XLSX

SHOW FLAGGED MEASUREMENTS

DATE	TIME	MEASURED BY	PH VALUE (PH)	FREE CHLORINE (MG/L)	COMBINED CHLORINE (MG/L)	TOTAL CHLORINE (MG/L)		
20.02.2023	16:31	Labs, Lilian	7.13	UR	0.19	0.19		
	15:04	Labs, Lilian	7.88	UR	UR	UR		
14.02.2023	15:55	Labs, Lilian	7.16	UR	0.74	0.76		

\* OFFSET APPLIED

Here you can select the time period for the measurements.

The measured values appear here.

The measurement data can be exported here.

You can comment on the measurements here.

© 2024 Lilian Labs GmbH. All rights reserved.

LEGAL NOTICE

PRIVACY POLICY

an Labs Manager

manager.lilianlabs.com/points/63eb9e387c7eac001ed743bb

LILIAN Manager Training

ENTITIES / LILIAN LAGUNA BEACH / SPORTBECKEN / AM BECKENRAND

SPORTBECKEN

Am Beckenrand

LAYOUT

List

RANGE

Last 100 measurements

GO TO...

GO TO POINT...

EXPORT AS .XLSX

SHOW FLAGGED MEASUREMENTS

DATE	TIME	MEASURED BY			COMBINED CHLORINE (MG/L)	TOTAL CHLORINE (MG/L)		
20.02.2023	16:31	Labs, Lilian	7.13	UR	0.19	0.19		
	15:04	Labs, Lilian	7.88	UR	UR	UR		
14.02.2023	15:55	Labs, Lilian	7.16	UR	0.74	0.76		

\* OFFSET APPLIED

You can activate the graphic view here.

Enables the display of measurements declared as faulty.

A measurement can be marked as faulty here.

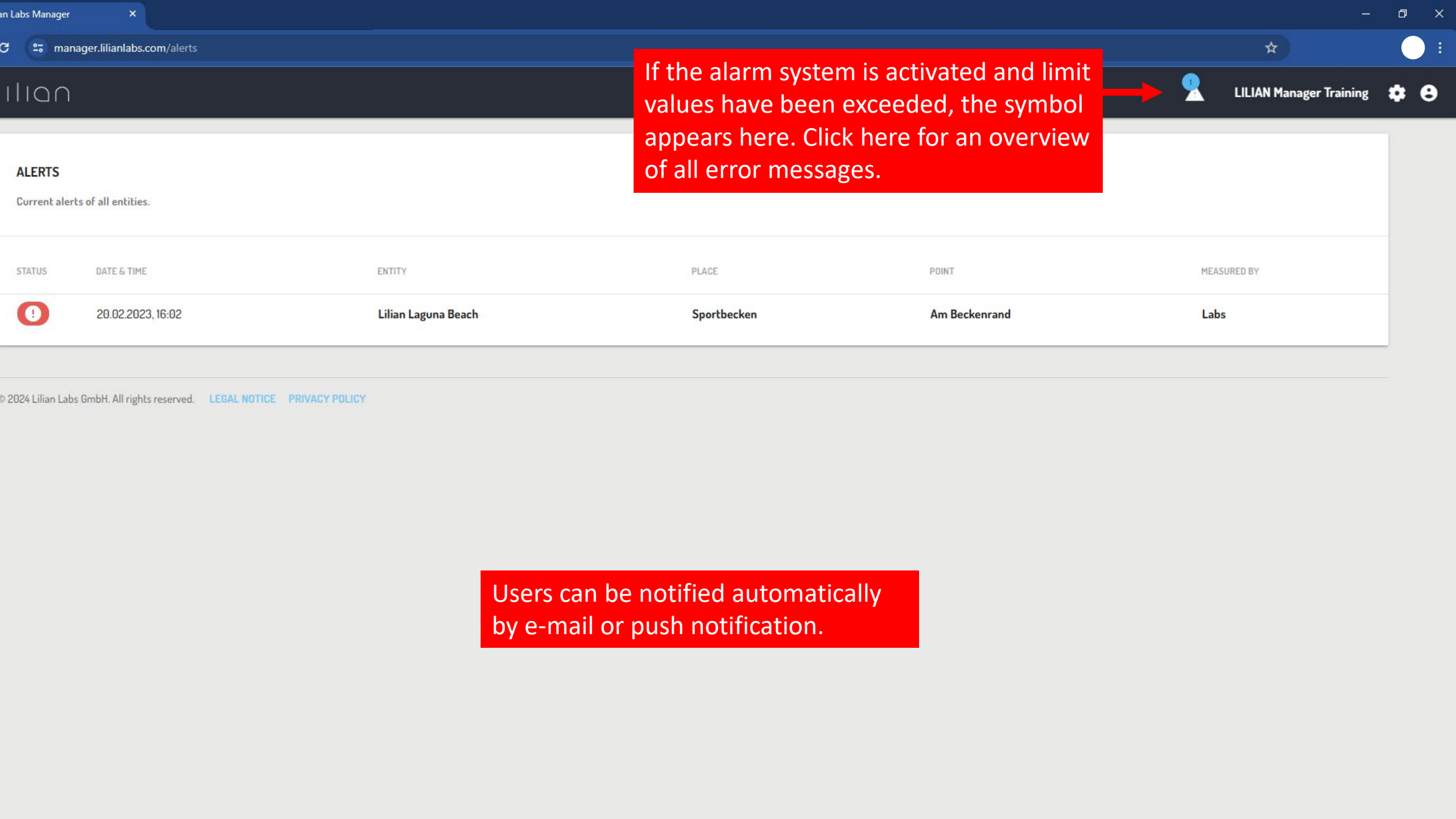

If the alarm system is activated and limit values have been exceeded, the symbol appears here. Click here for an overview of all error messages.

Users can be notified automatically by e-mail or push notification.

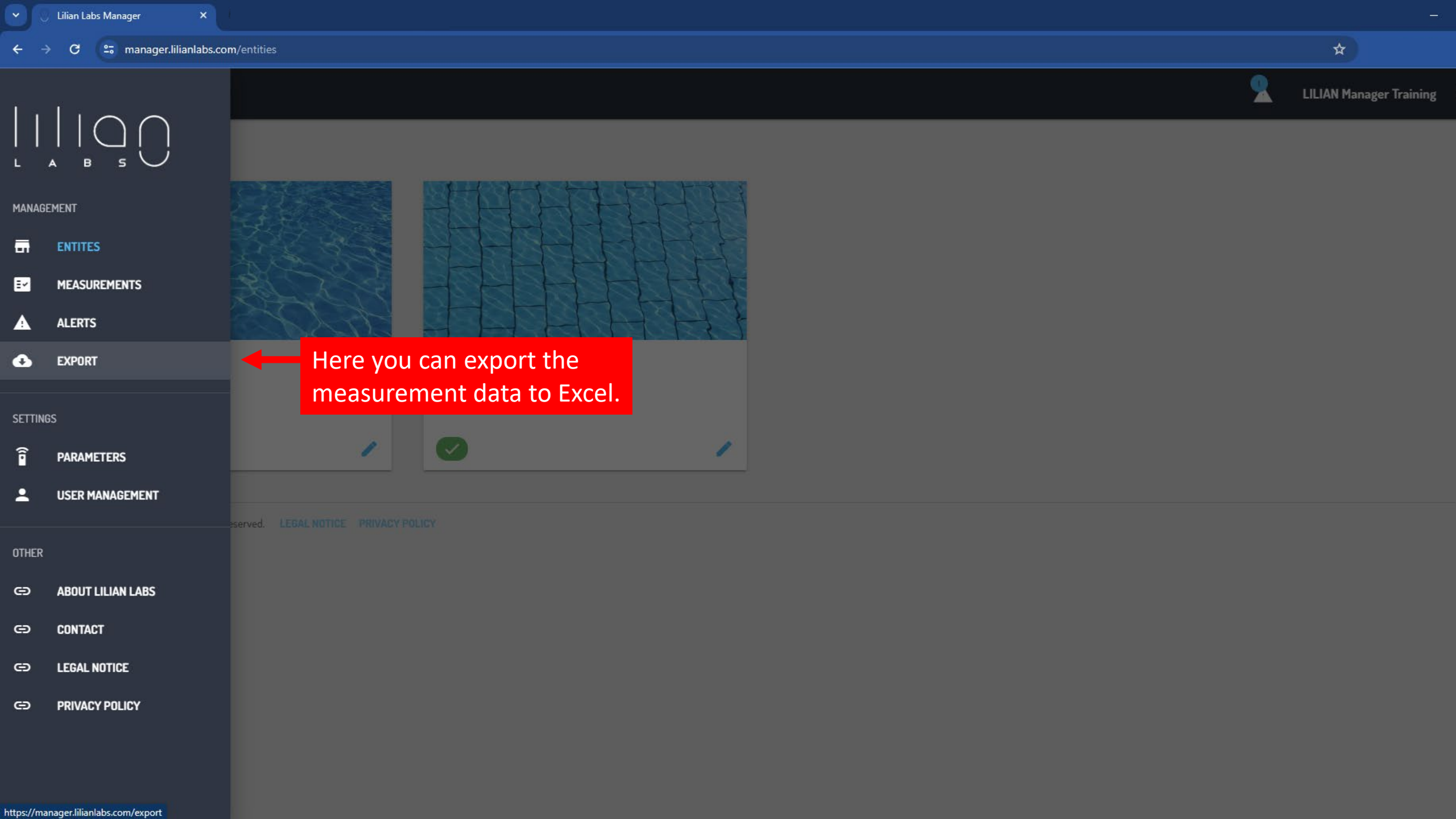

LILIAN LABS

MANAGEMENT

- ENTITES
- MEASUREMENTS
- ALERTS
- EXPORT

SETTINGS

- PARAMETERS
- USER MANAGEMENT

OTHER

- ABOUT LILIAN LABS
- CONTACT
- LEGAL NOTICE
- PRIVACY POLICY

Here you can export the measurement data to Excel.

an Labs Manager

manager.lilianlabs.com/export

LILIAN Manager Training

EXPORT

Export all measurements for a given time period.

RANGE

Current month

POINTS

Am Beckenrand at the basin

EXPORT AS .XLSX

© 2024 Lilian Labs GmbH. All rights reserved. [LEGAL NOTICE](#) [PRIVACY POLICY](#)



Select the period and the relevant facilities and pools. Then click here!





## MANAGEMENT

ENTITES

## MEASUREMENTS

 **ALERTS**

EXPORT

## SETTINGS

 PARAMETERS

 **USER MANAGEMENT**

## OTHER

 **ABOUT LILIAN LABS**

[CONTACT](#)

LEGAL NOTICE

[PRIVACY POLICY](#)

ADDITIONAL ENTITY

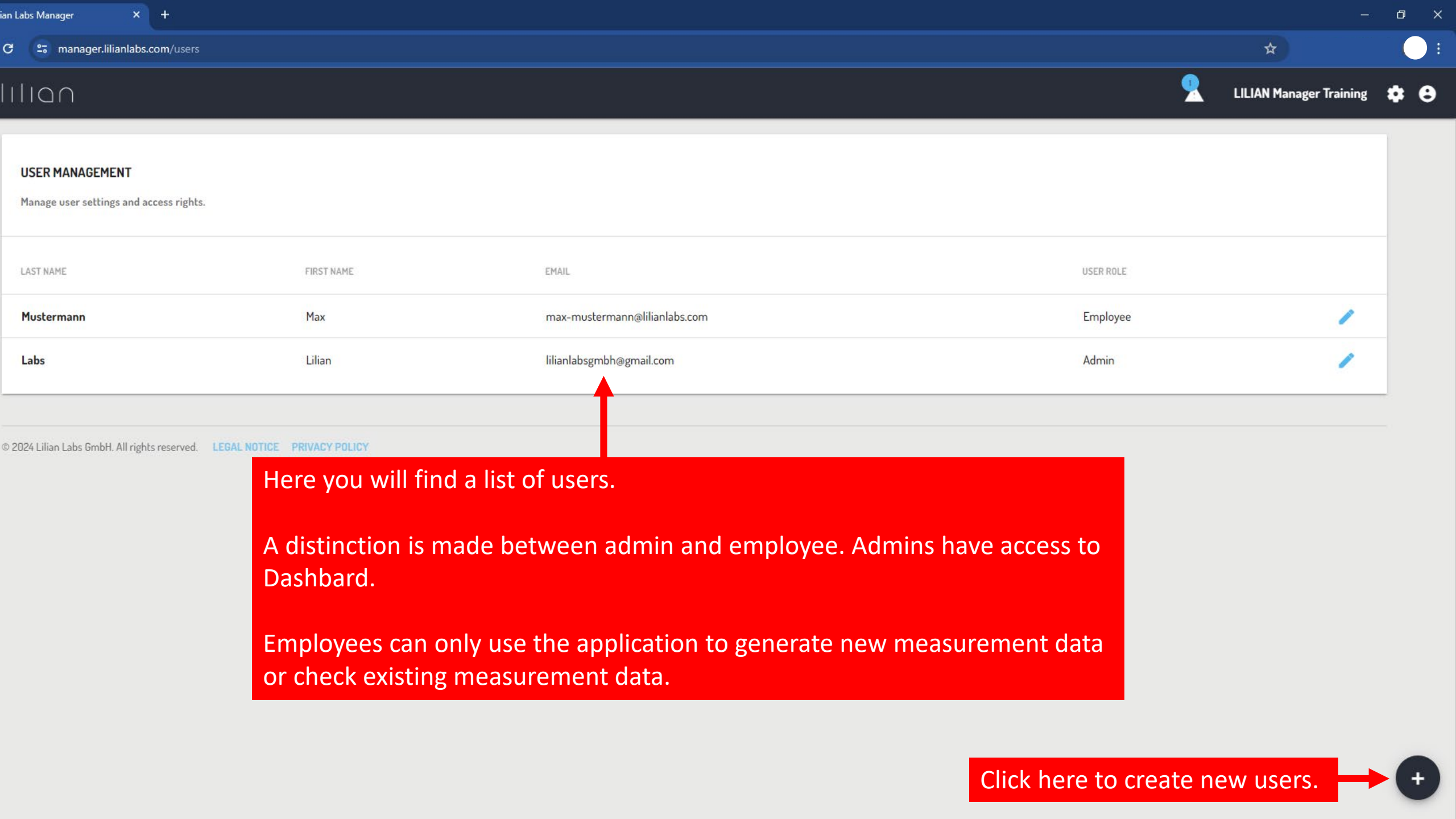

adress

Additional users can be created here.



## USER MANAGEMENT

Manage user settings and access rights.

LAST NAME	FIRST NAME	EMAIL	USER ROLE	
Mustermann	Max	max-mustermann@lilianlabs.com	Employee	
Labs	Lilian	lilianlabsgmbh@gmail.com	Admin	

Here you will find a list of users.

A distinction is made between admin and employee. Admins have access to Dashboard.

Employees can only use the application to generate new measurement data or check existing measurement data.

Click here to create new users.



in Labs Manager

manager.lilianlabs.com/users

LILIAN Manager Training

USER MANAGEMENT

Manage user settings and access rights.

LAST NAME	FIRST NAME	USER ROLE
Mustermann	Max	Employee
La		Admin

USER

FIRST NAME

LAST NAME

USER ROLE

LANGUAGE

EMAIL

COMPANY

MOBILE PHONE

PHONE

WHEN A VALUE IS OUT OF RANGE SEND A NOTIFICATION VIA...

PERMITTED ENTITIES

DELETE

CANCEL

UPDATE

Enter all the necessary data here and click on "Create".

The user will automatically receive a password to the e-mail address provided.



## Lilian Labs GmbH

Salzdahlumer Strasse 196  
38126 Braunschweig  
Germany

Phone. +49 531 – 387 274 36  
Email. [info@lilianlabs.com](mailto:info@lilianlabs.com)  
Web. [www.lilianlabs.com](http://www.lilianlabs.com)

LILIAN Manager: <https://manager.lilianlabs.com>

## Follow us on social media:



Instagram



Facebook



LinkedIn

Changing how we think about water analysis